



Master Fluid
SOLUTIONS™

USER MANUAL

ChipOut Plus™

Magnetic Centrifugal
Sludge & Chip Remover



TABLE OF CONTENTS

Precautions and Disclaimer Prior to Use	02
Specification and Appearance	03
Operation Steps	05
Filter Maintenance	06
Magnetic Separator Maintenance	10
Pump Maintenance & Replacement	12
Warranty	16



ChipOut Plus™ Magnetic Centrifugal Sludge & Chip Remover

PRECAUTIONS AND DISCLAIMERS PRIOR TO THE USE

1. Confirm the voltage is correct and confirm to connect the power supply.
2. Before use, make sure that there is no corrosive solvent in the cutting fluid of the water tank to avoid damage to the machine.
3. If there is any abnormal sound or smoke and fire during operation, please turn off the power immediately and contact our local agent.
4. When engage in inspection, adjustment or cleaning, the power must be turned off to prevent any liquid seeping into the electrical body, in order to avoid leakage and failure.



ChipOut Plus™

Magnetic Centrifugal Sludge & Chip Remover

SPECIFICATION AND APPEARANCE



Model	ChipOut Plus™
Net Weight	77kg
Dimensions	750*600*1250 mm
Front Filter	5.5 L
Pump Capacity	45-90Liters/per min, tested with water
Air Pressure	0.5 Bar-8.3 Bar (7.25Psi-120 Psi)
Voltage	Single Phase 220V, 50Hz or 110V, 60Hz



ChipOut Plus™

Magnetic Centrifugal Sludge & Chip Remover

- 1 Air Switch
- 2 Air Pressure
- 3 Power Switch
- 4 Air Hose Connector
- 5 Power Outlet

- 6 Inlet
- 7 Air Pressure Relief Valve
- 8 Front Filter

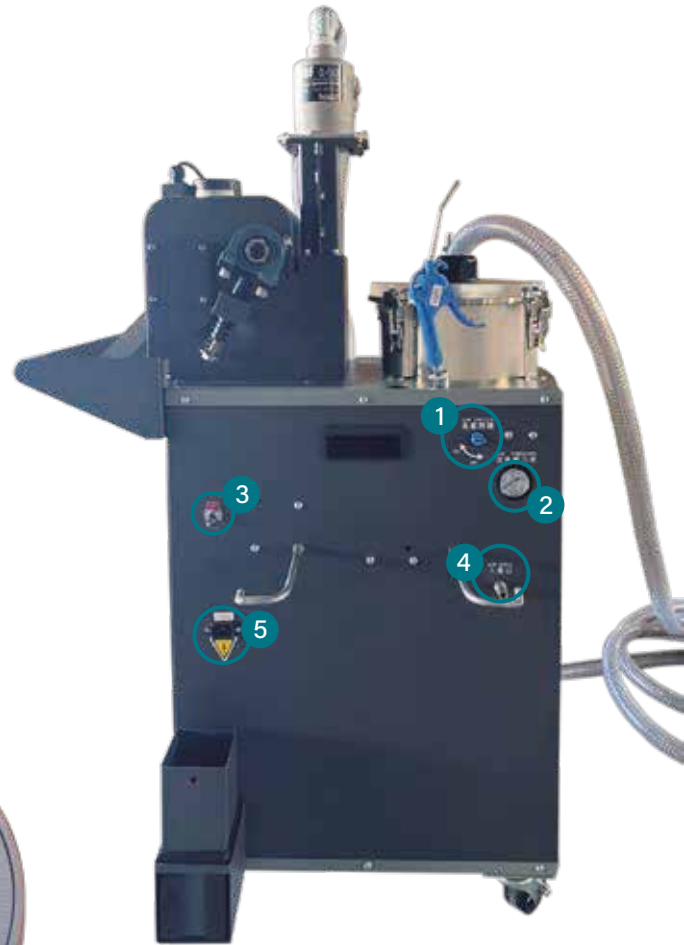

- 9 Vortex Dynamic Filter VDF
- 10 High Magnetic Separator
- 11 Sludge Discharge
- 12 Outlet Hose

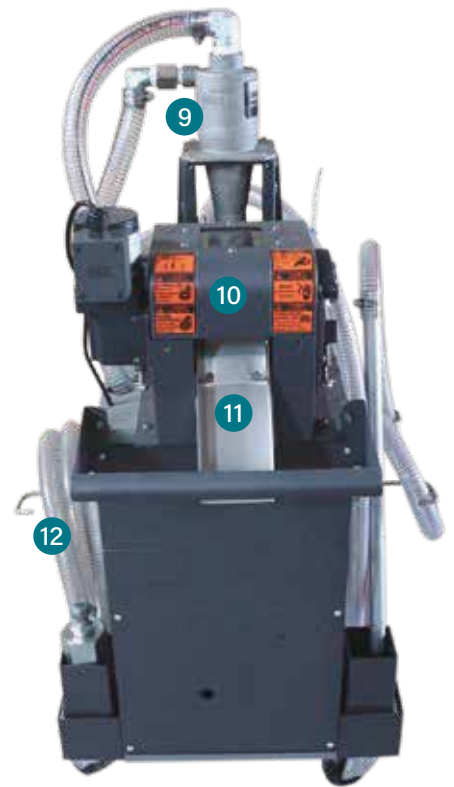



ChipOut Plus™

Magnetic Centrifugal Sludge & Chip Remover

OPERATION STEPS

- STEP 1** Connect the air hose.
- STEP 2** Place both inlet and outlet hoses in your coolant tank.
- STEP 3** Ensure that the relieve valve is switched off.
- STEP 4** Connect the power cord and turn on the power.
- STEP 5** Turn on the air switch to start cleaning.



STEP 6

Essential maintenance

When operation is completed and before putting the unit to idle, please run the unit with water or clean fluid for about 1 - 2 minutes to prevent sludge remained and stuck inside the unit.

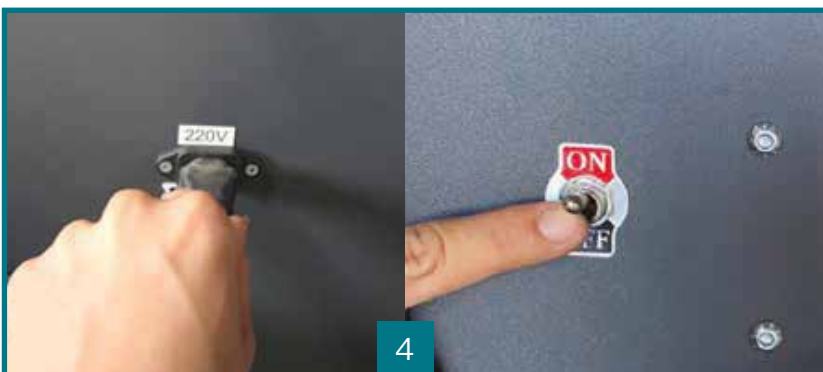
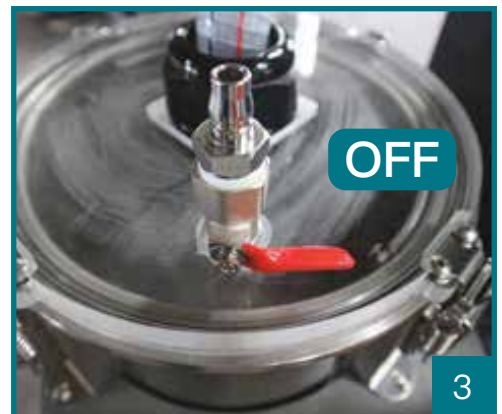



ChipOut Plus™

Magnetic Centrifugal Sludge & Chip Remover

THE MAINTENANCE OF THE FILTER



STEP 1

During the filtration process, visually check the filter at any time to see whether it has become full.



STEP 2

When finished, switch on the air pressure relief valve to let the filtered chips dry for about 30 sec, the air will be sucked in to squeeze out the remaining water from the filter.



STEP 3

Turn off the air switch.



ChipOut Plus™

Magnetic Centrifugal Sludge & Chip Remover



STEP 4

Hold the filter upside down and use the air gun or water to blow/clean the remaining impurities.

Follow this procedure for regular maintenance.



ChipOut Plus™

Magnetic Centrifugal Sludge & Chip Remover

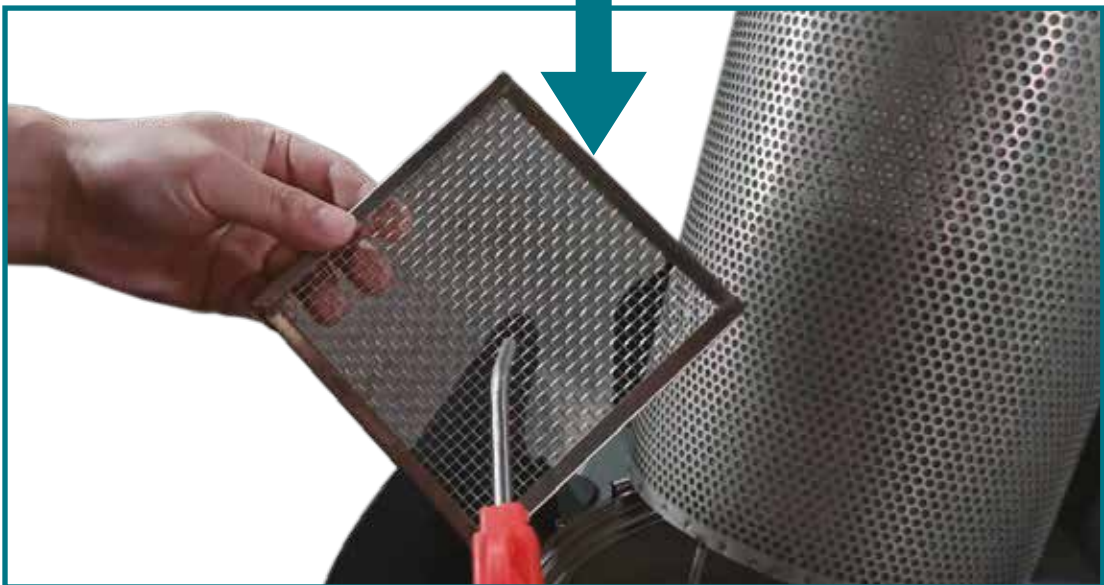
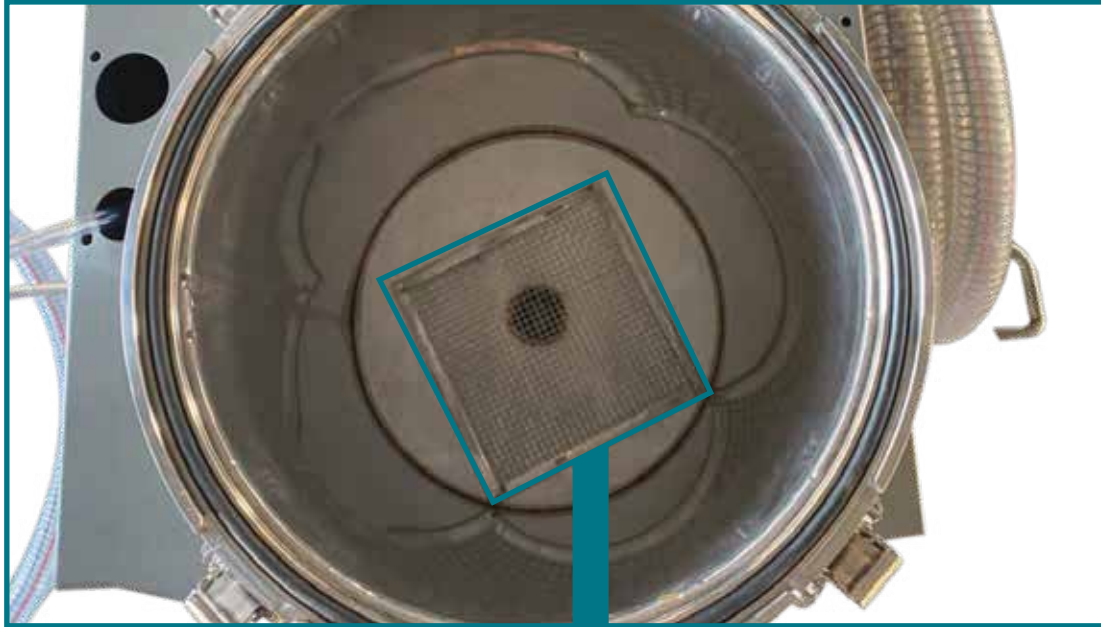

STEP 5

There's a rectangular mesh underneath the filter.
Clean this mesh regularly with the air gun or water as well.



ChipOut Plus™

Magnetic Centrifugal Sludge & Chip Remover

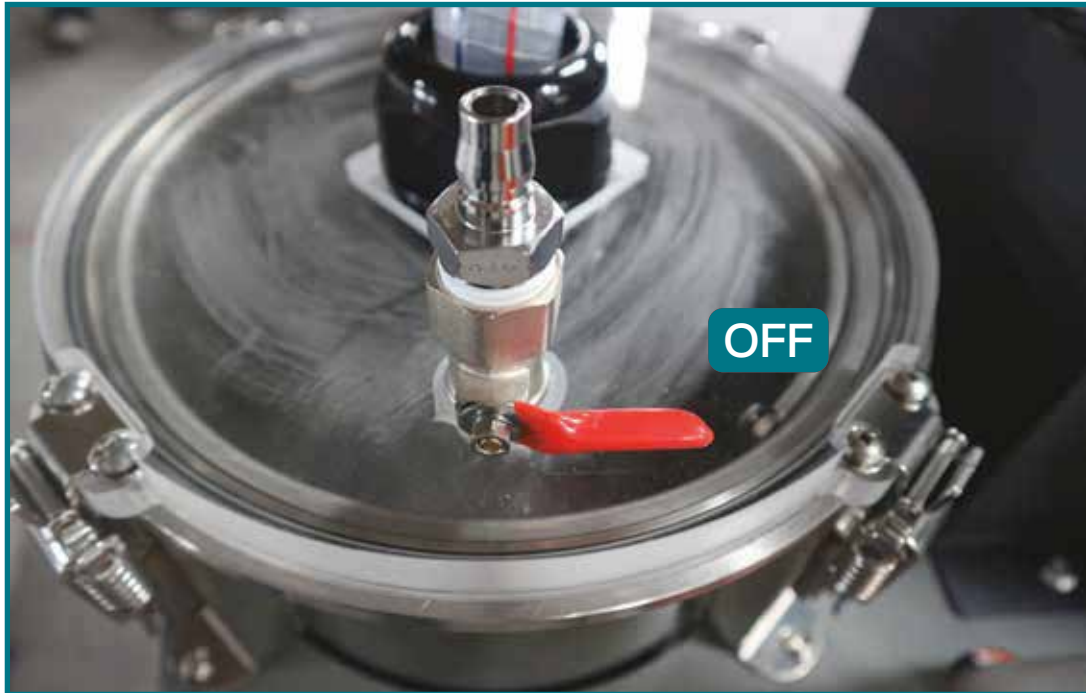

STEP 5

Switch the air pressure relief valve off when the maintenance is finished. Now it's ready for the next coolant tank cleaning task.

Notice: When operation is completed and before putting the unit to idle, please run the unit with water or clean fluid for about 3 minutes to prevent sludge remained and stuck inside the unit.



ChipOut Plus™ Magnetic Centrifugal Sludge & Chip Remover

MAGNETIC SEPARATOR MAINTENANCE

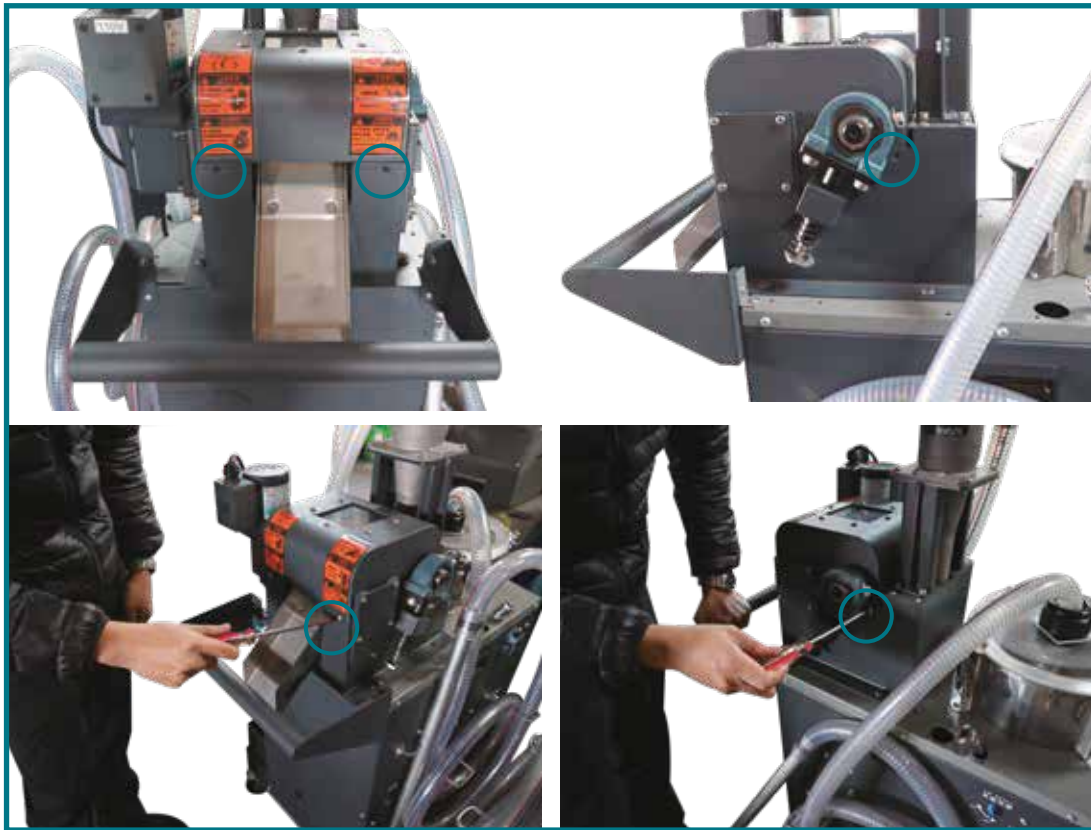

Loosen all 4 screws (2 at the front and one at each side) in order to open up the cover of the separator.





ChipOut Plus™

Magnetic Centrifugal Sludge & Chip Remover

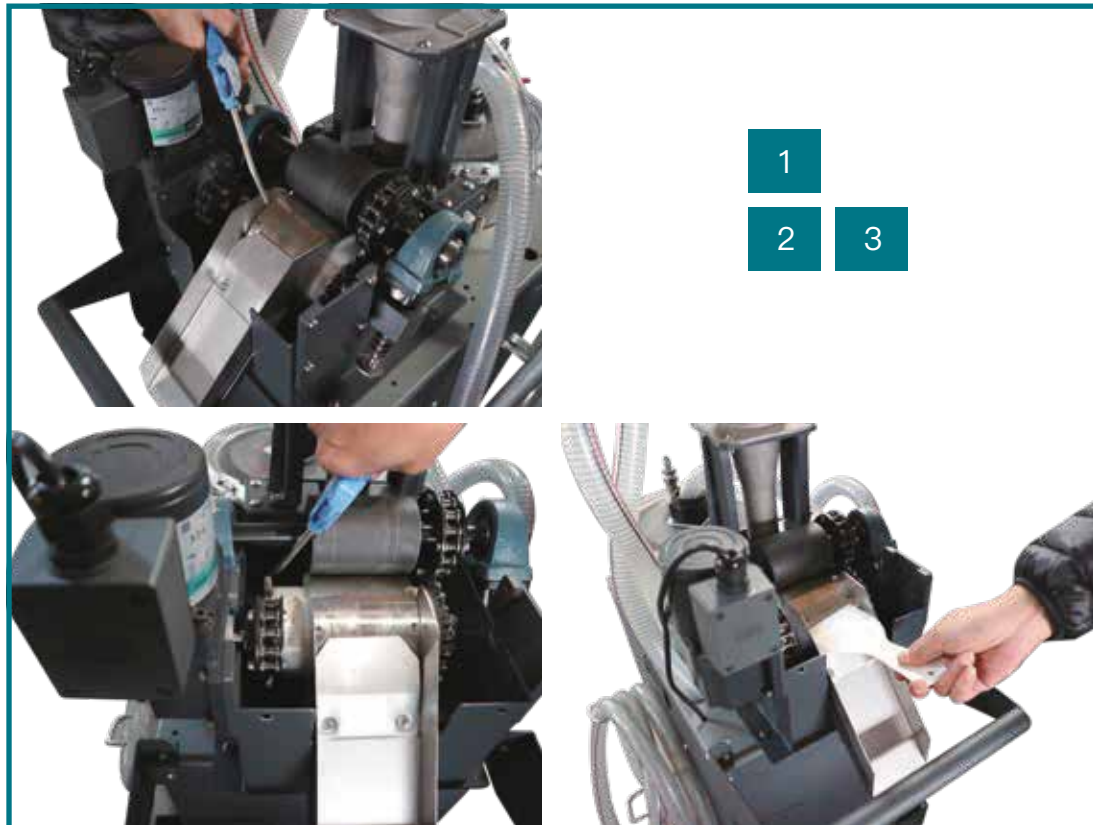

Use the scraper to remove the sludge on the discharge portal, and then use the equipped air gun to clean up all the possible particulates around the separator. Be sure there is no clogging or accumulation.



PNEUMATIC PUMP MAINTENANCE & REPLACEMENT

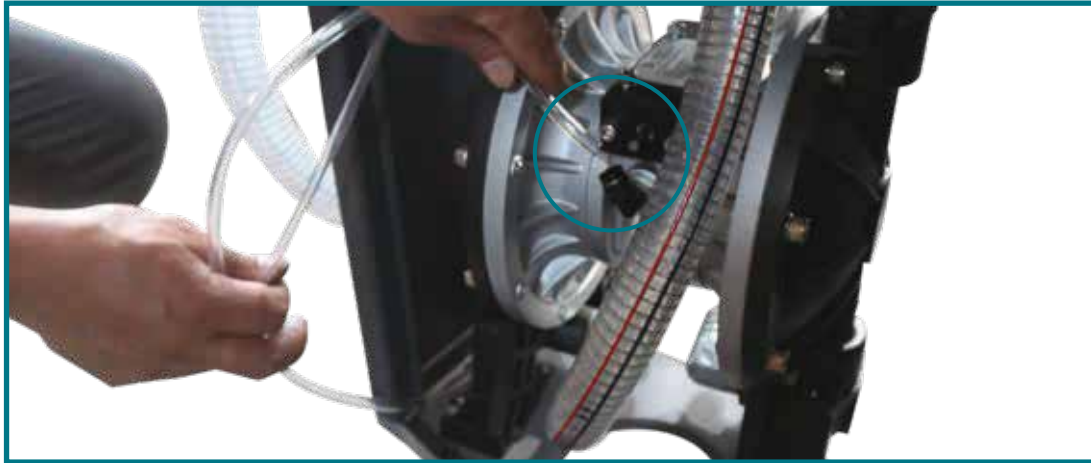

STEP 1

Open the front twist-to-open door and disconnect the air hose.

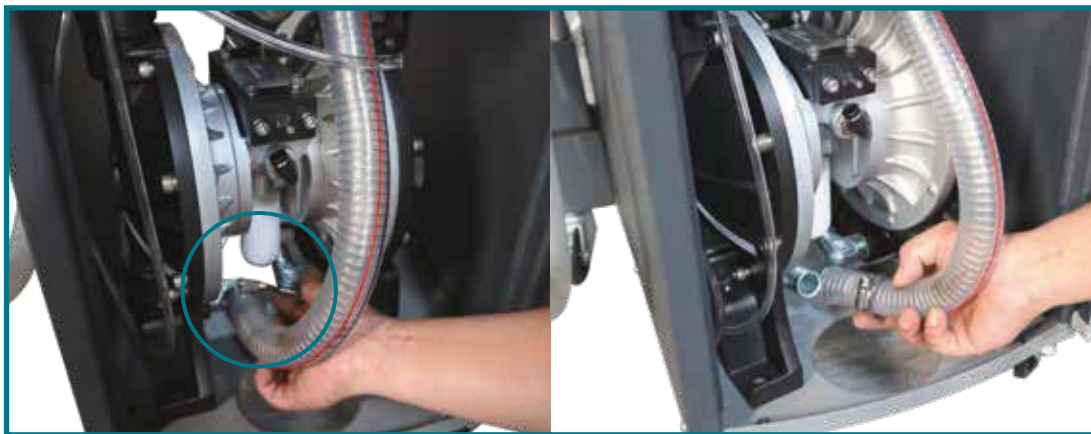

STEP 2

Loosen the screw & hose clamp to disconnect the front inlet hose.



ChipOut Plus™

Magnetic Centrifugal Sludge & Chip Remover



STEP 3

Unscrew the two screws, one left and one right beside the magnetic separator.



STEP 4

Remove all 6 screws on the rear plate.



ChipOut Plus™ Magnetic Centrifugal Sludge & Chip Remover



STEP 5

Before you disconnect the pipelines, do note and remember how they were originally installed to avoid re-installing confusion. The air pump is connected to total 4 pipes, 2 for inlet and 2 for outlet. Loosen all hose clamps and disconnect all the pipelines.



ChipOut Plus™

Magnetic Centrifugal Sludge & Chip Remover

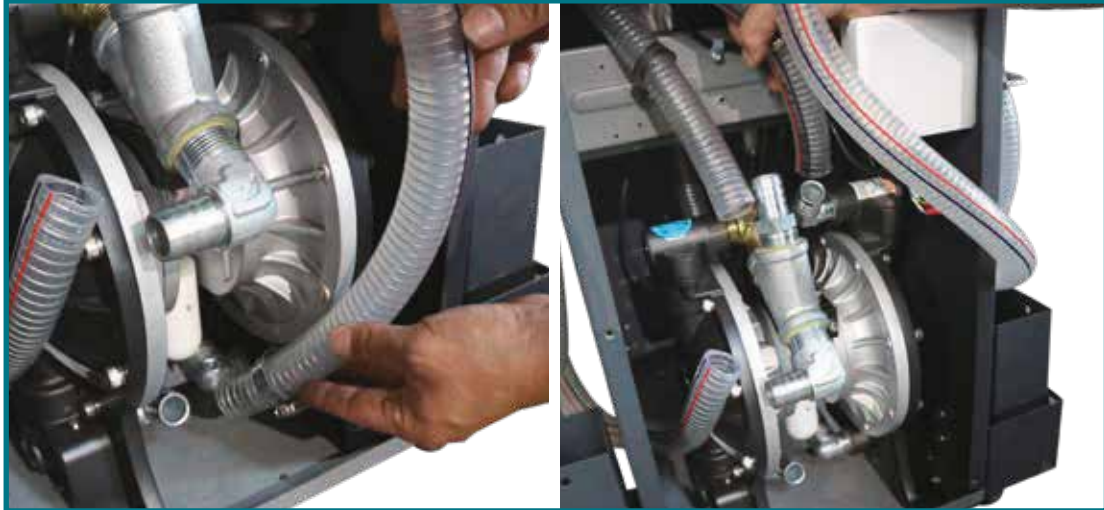

STEP 6

Pipelines disconnected as shown in the above pictures.

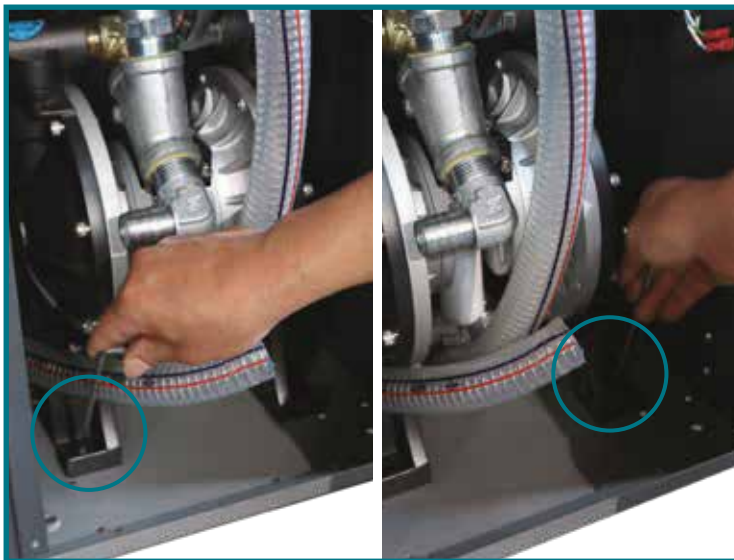

STEP 7

Remove the two screws fixed at the base and now you can replace the air pump.



MANUFACTURER'S WARRANTY CARD

Product name: XYBEX™ ChipOut Plus™

Model: ChipOut Plus™

Serial No.: _____

Quantity: _____ Set

Warranty period: _____ year _____ month _____ date

▪ **Manufacturer's guarantees:**

For units purchased from the official dealers of XYBEX that are naturally found with defects or with replacement requirements, will be able to apply for the free parts delivery and are requested for approval from either the dealers or the head branch of XYBEX.

▪ **Warranty period:**

12 months warranty starting from the date of receipt.

▪ **Warranty coverage:**

For newly purchased units that are within the warranty period will be provided with services of maintenance or replacement once approved and confirmed to be naturally defected or damaged.

User Info

Company name: _____

Applicant: _____

Phone: _____

Fax: _____

Address: _____

Machine Serial No.: _____

Date: _____



MASTER FLUID SOLUTIONS

www.masterfluids.com/ap/en-ap/

Mail: apac-info@masterfluids.com



Issue date: 2024-10-18